

**WISCONSIN STATE 4-H HORSE ASSOCIATION**

**21<sup>st</sup> ANNUAL 4-H HUNTER & DRESSAGE SHOW  
AND MINI EVENTS**

**JUNE 24-26, 2011**



**SHEBOYGAN COUNTY FAIRGROUNDS  
PLYMOUTH, WI**

**CLINICS**

**MINI EVENT WITH CROSS COUNTY CLINIC FOR  
ADVANCED/INTERMEDIATE RIDERS – FRIDAY, JUNE 24**

**OVER FENCES CLINIC – SATURDAY, JUNE 25**

**DRESSAGE SHOW – SATURDAY, JUNE 25**

**DRESSAGE CLINIC – SUNDAY, JUNE 26**

**OVER FENCES SHOW – SUNDAY, JUNE 26**

**WISCONSIN STATE 4-H HUNTER & DRESSAGE SHOW**  
**JUNE 24-26, 2011**  
**SHEBOYGAN COUNTY FAIRGROUNDS, PLYMOUTH, WI**  
**MINI EVENT WITH CROSS COUNTRY CLINIC FOR**  
**ADVANCED/INTERMEDIATE RIDERS - JUNE 24**

**FLAT CLASSES – JUNE 25**  
**OVER FENCES CLINIC - JUNE 25**  
**DRESSAGE SHOW - JUNE 25**  
**FLAT & PLEASURE CLASSES – JUNE 25, SAT EVENING**  
**DRESSAGE CLINIC - JUNE 26**  
**OVER FENCES SHOW - JUNE 26**

**SHOW MANAGERS:** Betsy Rohde, 920-994-9234 ([betsyjpll@aol.com](mailto:betsyjpll@aol.com))  
Sally and Ernie Anderson, 920-982-3169 ([sande@athenet.net](mailto:sande@athenet.net))  
Lori Schuessler, 920-946-4697 ([scottlori8@yahoo.com](mailto:scottlori8@yahoo.com))

**SHOW ENTRIES: Pre-entry ONLY, POSTMARKED by June 6<sup>TH</sup>**

\$10.00 per class

\$40.00 Stall Fee (stalls are not required – you may tie to trailer)

**(If you scratch and we RESELL your stall we will refund your stall fee)**

\$15.00 Clinic Fee / Group Jump, Dressage

\$25.00 Individual Dressage Lesson

\$85.00 Mini Event (includes Cross Country Clinic, Cross Country Class, Stadium Jumping, & Eventing Dressage and Lunch) All events completed on Friday, June 24<sup>th</sup>  
Sundance Farms, Plymouth for advanced riders  
Plymouth Fairgrounds for intermediate riders

**Clinic forms are available on the Internet under WI 4-H Horse Association Handbook: Clinics**

**MAKE CHECKS PAYABLE TO: WISCONSIN STATE 4-H HORSE ASSOCIATION**

*Returned checks will result in exhibitors inability to participate in any state activities until the check, and any incurred expenses, have been settled. \$25.00 NSF fee for any returned checks.*

**GENERAL PARTICIPATION RULES:**

1. **You may enter two equine at this show. Exhibitor may only enter a class once.**
2. **Hunter ponies may be entered in all hunter classes and will follow all guidelines for horses, including fence heights.**
3. **Only the eligible 4-H member can ride or work with their equine on show grounds. Noncompliance will be grounds for dismissal from the show and there will be no refunds of entry or stall fees.**
4. Horse must be appropriately tacked (saddle, bridle) and rider must be appropriately attired (boots, helmet and back number visible on rider's back) when riding on horse show grounds. **NO RIDING DOUBLE.**
4. **All dogs must be leashed and kept in camping area.**
5. **No stallions may be shown or permitted on show grounds.**
6. Horseless Horse Members may participate in clinics, Intro Dressage Classes.
7. The Mini Event is for A and B riders only!
  - A. **A riders ONLY - If you enter any A Jumping Class you may NOT enter any B & C with that horse (Fences will be 2'6" to 3'0")**
  - B. **B riders ONLY - If you enter any B Jumping Class you may NOT enter any A & C with that horse (Fences will be 2'3" to 2'6")**
  - C. **C riders ONLY - If you enter any C Jumping Class you may NOT enter any A & B with that horse (Fences will be 18" to 2')**

## ENTRY REQUIREMENTS

1. Entries must be received by date listed on show bill. Late entries will be rejected and returned.
2. Send entries to Executive Secretary. All four signatures are required, otherwise entries will be returned. (Clinic entries go to a separate address – see clinic show bill.)
3. You do not need a blue ribbon from your county fair to participate in this show.
4. Only members of the immediate family OR a 4-H youth paired with a Horseless Horse youth, are permitted to show the same project animal. Each family member may show any combination of classes provided the horse is only shown once in a specific class number (except for Dressage Classes).
5. Any non-therapeutic substance used as a stimulant, depressant, tranquilizer or sedative for the purpose of altering a horse or pony's show ring performance is prohibited. Failure to comply will result in disqualification.
6. Shavings will be available for purchase at show. Remember stalls must be stripped before you leave!
7. Participation requires pre-entry of all classes. No entry changes made at show.
8. Payment must accompany entry forms and must be stapled to entry forms that it covers.
9. Entry forms that are illegible will forfeit their entry and stall fees.
10. Equine may be brought onto the show grounds anytime after 5:00 p.m. Thursday. Horses will be stalled with their county unless special request to Betsy.
11. All exhibitors must bring their own feed and equipment. You are responsible for the care of your equipment and animal at all times. You are expected to keep your stalls and trailer area clean. Stalls must be vacated and stripped in a timely fashion after the show. Please clean up the fairgrounds after yourselves.
12. Refunds only with a doctor's or vets excuse. Stall fees are not refunded (unless stall is resold). Request for refunds will not be considered unless notification is received PRIOR TO the show and documents are postmarked within one week of the show.)
13. The Wisconsin State 4-H Horse Association rules and guidelines will be followed at this show. Guidelines are available from your UWEX 4-H & Youth Agent. Or on the web @ [www.uwex.edu/ces/4h](http://www.uwex.edu/ces/4h) (go to projects, horses and then to handbook). A reference copy will be available at the show.
14. Copy of negative Coggins test taken within current year for each horse/pony must accompany entry. YOU WILL SHOW YOUR ORIGINAL WHEN YOU CHECK IN AT THE SHOW.
15. You must send your premise ID# with your registration.

ANY ACT OF DISCOURTESY TO JUDGE OR SHOW OFFICIALS BY AN EXHIBITOR  
OR ANY OTHER ATTENDANT WILL BE GROUNDS FOR DISQUALIFICATION  
AND FORFEITURE OF FEES.  
CRUELTY TO OR ABUSE OF A HORSE WILL NOT BE TOLERATED!

## TACK AND ATTIRE

1. SEI equine approved safety helmets (with safety harness securely fastened) must be worn at all times when exhibitor is riding equine on the show grounds.
2. Jumping vests are encouraged. (In all jumping classes and required for A level Mini Event.) You may attach your number to the Vest
3. Exhibitors must wear their exhibitor number at all times when on show grounds. Please wear your number on your back unless in the show ring!
4. Boots with heels and appropriate tack must be used when mounted on show grounds.
5. An English type saddle with stirrups is compulsory at all levels.
6. Dressage - a plain snaffle bridle and regular cavesson made of leather are required. (You may use a dropped nose band, a flash nose band, a crescent nose band or a crossed nose band)

**7. Acceptable bits for dressage: PERMITTED SNAFFLES\***

**(Must be used in Training-Second Level Tests. Optional in Third and Fourth Level Tests)**

- a. Ordinary snaffle with single-jointed mouthpiece.
- b. Ordinary snaffle with double-jointed mouthpiece.
- c. Racing snaffle (D-ring).
- d. Snaffle. 1) with cheeks, with or without keepers. 2) without cheeks (Egg-butt)
- e. Snaffle with upper or lower cheeks.
- f. Unjointed snaffle (Mullen-mouth)
- g. Snaffle with cheeks. (Hanging or drop cheek; Baucher). This may be a D-ring or other ordinary snaffle as pictured in a-f.
- h. Dr. Bristol
- i. Fulmer
- j. French snaffle
- k. Snaffle with rotating mouthpiece.

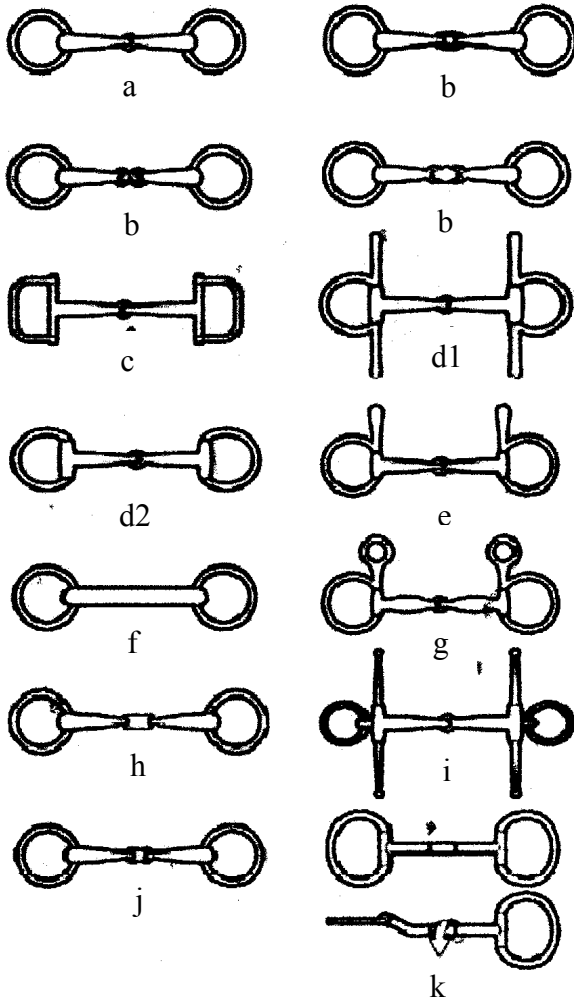

\* Any of the above may be covered with rubber or leather. Bits with mouthpieces made of synthetic material are permitted, provided that the contours of the bit conform to the contours of one of the bits pictured above.

*Dressage Attire/Equipment updated 5/10/04*

- 8. Dressage whip length guidelines. Whips must be less than 43.3 inches (110 cm) including lash.**
9. Leg wraps or boots are allowed for Hunters/Jumpers shown in equitation on the flat only.
10. No running or standing martingales allowed *except* in over fences classes.

## DRESSAGE:

1. Each Horse/Rider combination may enter two (2) consecutive levels (e.g. intro & training, training & level 1.)
2. In the percentage ride, you ride any dressage test that you have not already ridden. Your placing depends on comparing your % score with the other riders % score. (Please keep to 2 consecutive levels.) **This is your chance to ride a test not normally offered.**
3. Bits will be checked- If you are unsure ask first!
4. Pas de Deux and Musical Kur will be ridden in a large or a standard size ring. Please notify the show office what size ring you need and label music. **A Musical Kur is a test done in a dressage ring, using standard dressage movements put together in any order you choose, to music. The test is judged on creativity, artistry, music suitability and accuracy. A Pas de Deux is a Musical Kur with 2 riders/horses. (You may ride a Musical Kur at an intro or training level. We have copies of intro and training guidelines for Musical Kur, call Betsy to request.) First level and up are USDF tests and must be ridden in a large ring.**

## WHAT IS A HUNTER?

The modern sport of show hunters derives from the very old and classic sport of field hunting. Today's show hunter is ridden both on the flat and over fences. Those horses should be quiet, calm and mannerly; yet elegant.

On the flat they are judged on their gaits, their way of going, their manners and suitability to their job. Hunters should have long, low ground covering strides and carry a steady, even pace.

Over fences they are judged on pace, manners, jumping form and style. A typical hunter course consists of approximately 8 jumps that simulate natural obstacles. The jumps are set at a consistent height, ie: 2'0", 2'3", 3'0", etc. The courses are carefully measured and should have a set amount of strides in-between the jumps. A standard stride is 12 feet.

While many breeds are used for hunters, use a breed that can produce the longer strides and jumping form needed in a successful show hunter.

## WHAT IS A JUMPER?

A Jumper is a horse or any breed that shows strictly over fences. A typical jumper course consists of 10 - 16 fences. The jumps are brightly colored and often difficult types of fences such as triple bars, water jumps, etc.

A Jumper course is designed to test a horse's athletic ability so the jumps are not only high but often wide. As well, the strides between the jumps can be set to create problems for the horses and riders to solve.

There are many levels of jumpers and many, many types of classes. In the most common jumper class, a horse and rider will jump the first round, then, if they are clean, in other words no faults, they will come back and jump a second round over a higher but shorter course for speed with the best time and score winning.

While any horse with enough jumping ability may be a jumper, most often Thoroughbreds and European Warmblood breeds are most suited for this job.

Jumpers are an exciting spectator sport and quickly rising in popularity.

At this show the classes are hunter classes except for Obstacle Jumping which is a timed event.

## HUNTER HACK:

1. Horses are required to jump two fences. (Jumps do not need to be set in a line. If the jumps are in a line they are to be set 36-60 feet apart with a 12 foot interval between jumps.)
2. Horses will be asked to walk, trot, and canter both ways of the ring. At the discretion of the judge contestants may be asked to hand gallop, pull up and stand quietly following the last fence.
3. Class will be judged on flat work, manners, way of going, style over fences and even hunting pace.

4. Placing for the class will be determined by allowing the maximum of 30% for flat work.

\* Faults over fences are to be judged as in working hunter.

\* Faults on rail work include:

- 1) Being on wrong lead.
- 2) Excessive speed or slowness at any gait.
- 3) Breaking gait.
- 4) Failure to take called for gait when asked.
- 5) Head carried too low or too high.
- 6) Nosing out or flexing behind the vertical.
- 7) Opening mouth excessively
- 8) Stumbling or falling.

**OBSTACLE JUMPING: \*\*Classes to be run Sunday**

Each rider will have 45 seconds to complete their pattern. Points will be assigned to each jump. At the bell the rider enters the ring and takes the jumps in any order they choose. They may not jump the same jump without separating it by a different jump. If a rail is knocked down that jump is out of the rotation for that rider.

**MINI EVENT:**

Grand, Reserve and eight (8) top ten ribbons will be awarded. Disqualified entries are NOT eligible for awards. Dressage rides of less than 50% are not eligible for awards. The placings will be judged on points awarded in Cross Country, Stadium Jumping, and Eventing Dressage. You must sign up for MINI EVENT on the hunter/dressage entry form. Indicate Advanced or Intermediate. All classes will be run on Friday of the show. Advanced riders will use Novice B test. Intermediate riders will use Novice A. Dressage tests are available at [www.useventing.com](http://www.useventing.com) go to resources for competitors/riders then to Dressage tests to download a copy.

**WORKING HUNTER OVER FENCES:**

1. A hunter course shall be a fair test of a hunter, with a minimum of 4 obstacles.
2. Horse to jump a maximum of 8 fences.
3. One change of direction is mandatory.
4. The top element of all fences must be securely placed so that a slight rub will not cause a knock down.
5. The class will be judged on manners, way of going, and style of jumping.
6. Horse shall be credited with maintaining an even hunting pace that covers the course with free flowing strides.
7. Preference will be shown to horses with correct jumping style that meets fences squarely, jumping at the center of the fence.
8. Judges shall penalize unsafe jumping and bad form over fences, whether touched or untouched, including: twisting, incorrect leads around the ends of the course, or cross-cantering.
9. Ins and outs must be taken in the correct number of strides or be penalized.
10. Any error which endangers the horse or rider, particularly refusals or knock downs, shall be heavily penalized.

**GREEN HUNTER:**

1. Horse/rider combination to never have won a blue ribbon in a jumping class EXCEPT Hunter Hack.
2. The same rules as working hunter.

**4-H CLASSIC MEDAL (for experienced rider) A Classes ONLY:**

1. To be judged on equitation.
2. Class is judged as an equitation class over a "jumper style" course. IT IS NOT TIMED
3. Elements may be called for including: trotting on course, dropping irons, narrower fences, roll top fences, liverpool, etc.

**HANDY HUNTER:**

A riders – Over Fences will be asked to perform horsemanship tasks at some fences.

**JUDGES CHOICE:**

C riders – Trot over x rails/jumps. Judge will pick your course.

**CHOOSE YOUR OWN LINE:**

A riders – 8 jumps. You may pick your own line but every fence **MUST** be jumped **ONLY** once. This class is judged on time.

**MINI CLASSIC MEDAL (for experienced rider) B Classes ONLY:**

1. To be judged on equitation.
2. Class is judged as an equitation class over a “jumper style” course. **IT IS NOT TIMED**
3. Elements may be called for including: trotting on course, narrower fences, etc.

**ELIMINATION:**

1. **Second** refusal, run out, bolting on course, extra circle, or combination of these.
2. Fall of horse and rider.
3. Bolting from ring.
4. Failure to keep proper course.
5. Taking a jump at any time if a rail is down on that jump.

**GENERAL:**

1. All horses must be serviceably sound.
2. Horse will not be requested to jump course more than once. In case of broken equipment, the rider may stop and correct the difficulty with a penalty the same as any loss of forward impulsion.
3. When an obstacle requires two or more fences (in and out) faults committed at each obstacle are considered separately.
4. At the judges discretion a Grand, Reserve, and eight Top Ten ribbons may be awarded in each class.

**FOOD:** A food stand will be available on the grounds.

**Box lunches for the Mini Event on Friday will be available for \$5.00 for parents, leaders, etc.**

Wisconsin 4-H will host a dinner at 6:30 PM on Saturday. All are invited!

**RIDING AREAS:**

You may only be mounted in designated areas. (Areas will be posted in the barns)  
Schooling fences will be available but no schooling over course will be allowed.

**TIMES:**

Dressage times will be posted Friday night.

Clinic times will be posted Friday evening.

Mini Event will start at:

8 AM for advanced riders – dressage test will be Novice B **(2010)**

9 AM for intermediate riders – dressage test Novice A **(2010)**

Dressage tests for eventing are available at [www.useventing.com](http://www.useventing.com) go to resources for competitors/riders then to Dressage tests to download a copy.

(You may contact Betsy Rohde (920-994-9234 or 414-315-4170 cell) on Wednesday, June 22 for clinic ride times)

**Please note on your clinic entry if you have time preferences.**

*WE NEED PRIVATE AND COUNTY SPONSORS TO HELP PAY FOR THIS SHOW  
PLEASE CONTACT ANY OF THE SHOW MANAGERS.*

**Please send sponsorships for this show by the June 6<sup>th</sup> deadline**

WE NEED VOLUNTEERS . . .

PLEASE CONTACT BETSY ROHDE TO PICK YOUR JOB/TIMES (920-994-9234)

**DIRECTIONS:**

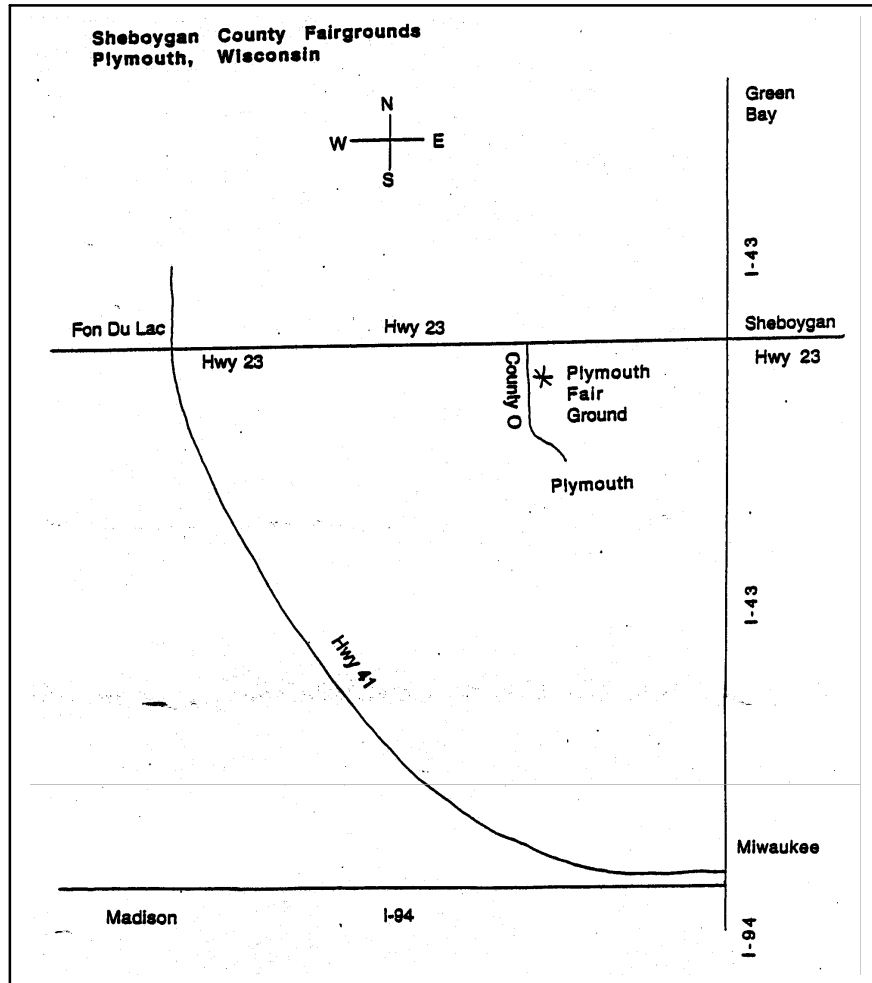

<b>MOTELS:</b>	Stafford Inn	920-893-0552
	Americinn	920-892-2669
	Plymouth Inn	920-893-5623
	Crest Motel	920-893-6111
	Baymont Motel	920-893-6781

**CAMPING: Limited Electrical & Water Hookups \$20.00 night (\$50 for 3 nights)**

**\*Pay Betsy when you hook up!**

**Tents are allowed – NO OPEN FIRES**

**Coin Showers are now available**

***STALLS ARE AVAILABLE AFTER 5 P.M. THURSDAY***

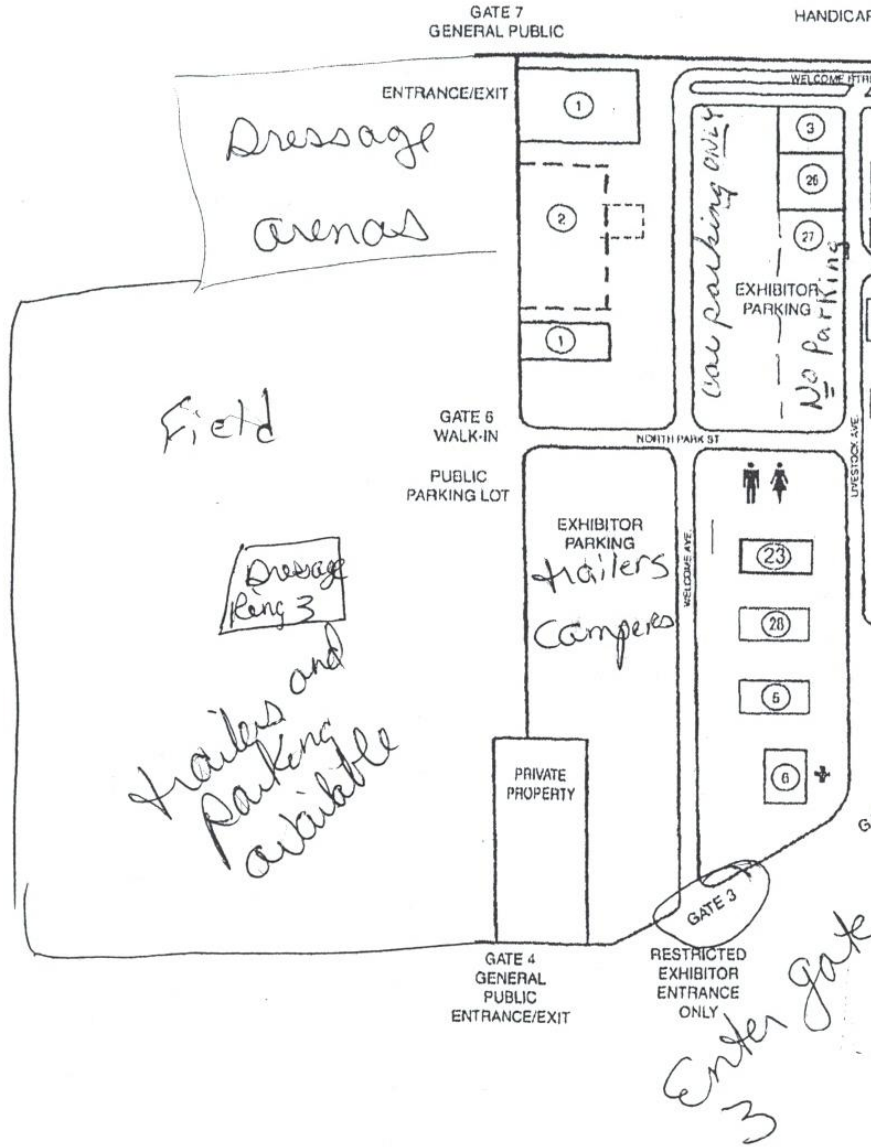

**Fairgrounds: Enter gate 3. You must park to the North of Welcome Avenue for trailers and campers. See Map.**

# WISCONSIN STATE 4-H HUNTER & DRESSAGE SHOW

## 2011 CLASS LIST

### FRIDAY, JUNE 24 – MINI EVENT

ADVANCED  
INTERMEDIATE

### SATURDAY, JUNE 25 – DRESSAGE BEGINS AT 8:00 A.M.

1. MUSICAL KUR, GRADE 6-13 (SINGLE RIDER)
2. MUSICAL KUR, GRADE 6-13 (2, 3 OR 4 RIDERS)
3. 2011 USDF SECOND LEVEL - TEST 1, GRADE 6-13
4. 2011 USDF FIRST LEVEL – TEST 2, GRADE 6-13
5. 2011 USDF FIRST LEVEL - TEST 1, GRADE 6-13
6. PERCENTAGE RIDE (%), GRADE 6-13
7. 2011 USDF TRAINING LEVEL - TEST 2, GRADE 10-13
8. 2011 USDF TRAINING LEVEL - TEST 2, GRADE 6-9
9. 2011 USDF TRAINING LEVEL - TEST 1, GRADE 10-13
10. 2011 USDF TRAINING LEVEL - TEST 1, GRADE 6-9
11. 2011 USDF INTRO - TEST B, GRADE 6-9, AHSA
12. 2011 USDF INTRO - TEST B, GRADE 10-13, AHSA
13. 2011 USDF INTRO - TEST A, GRADE 6-9, AHSA
14. 2011 USDF INTRO - TEST A, GRADE 10-13, AHSA

### SATURDAY, JUNE 26 - Not to start before 5 P.M.

15. EQUITATION ON THE FLAT, GRADE 11-13
16. EQUITATION ON THE FLAT, GRADE 8-10
17. EQUITATION ON THE FLAT, GRADE 6-7
18. WORKING HUNTER ON THE FLAT, GRADE 11-13
19. WORKING HUNTER ON THE FLAT, GRADE 8-10
20. WORKING HUNTER ON THE FLAT, GRADE 6-7

### SUNDAY, JUNE 26 – HUNTER CLASSES BEGIN AT 8 A.M.

21. HANDY HUNTER 8-10 AM (in cross country course)  
In Arena
22. HUNTER HACK, B
23. HUNTER HACK, C
24. WORKING GREEN HUNTER OVER FENCES, B
25. WORKING GREEN HUNTER OVER FENCES, C
26. WORKING HUNTER OVER FENCES, C
27. HUNTER EQUITATION OVER FENCES, C
28. TIMED OBSTACLE JUMPING A
29. TIMED OBSTACLE JUMPING B
30. CHOOSE YOUR OWN LINE A
31. JUDGES CHOICE (TROT) OVER CROSS RAIL C
32. WORKING HUNTER OVER FENCES, B
33. HUNTER EQUITATION OVER FENCES, B
34. MINI MEDAL CLASS B ONLY
35. WORKING HUNTER OVER FENCES, A
36. HUNTER EQUITATION OVER FENCES, A
37. 4-H CLASSIC MEDAL, A ONLY