

Map 5.5 Groundwater Flow

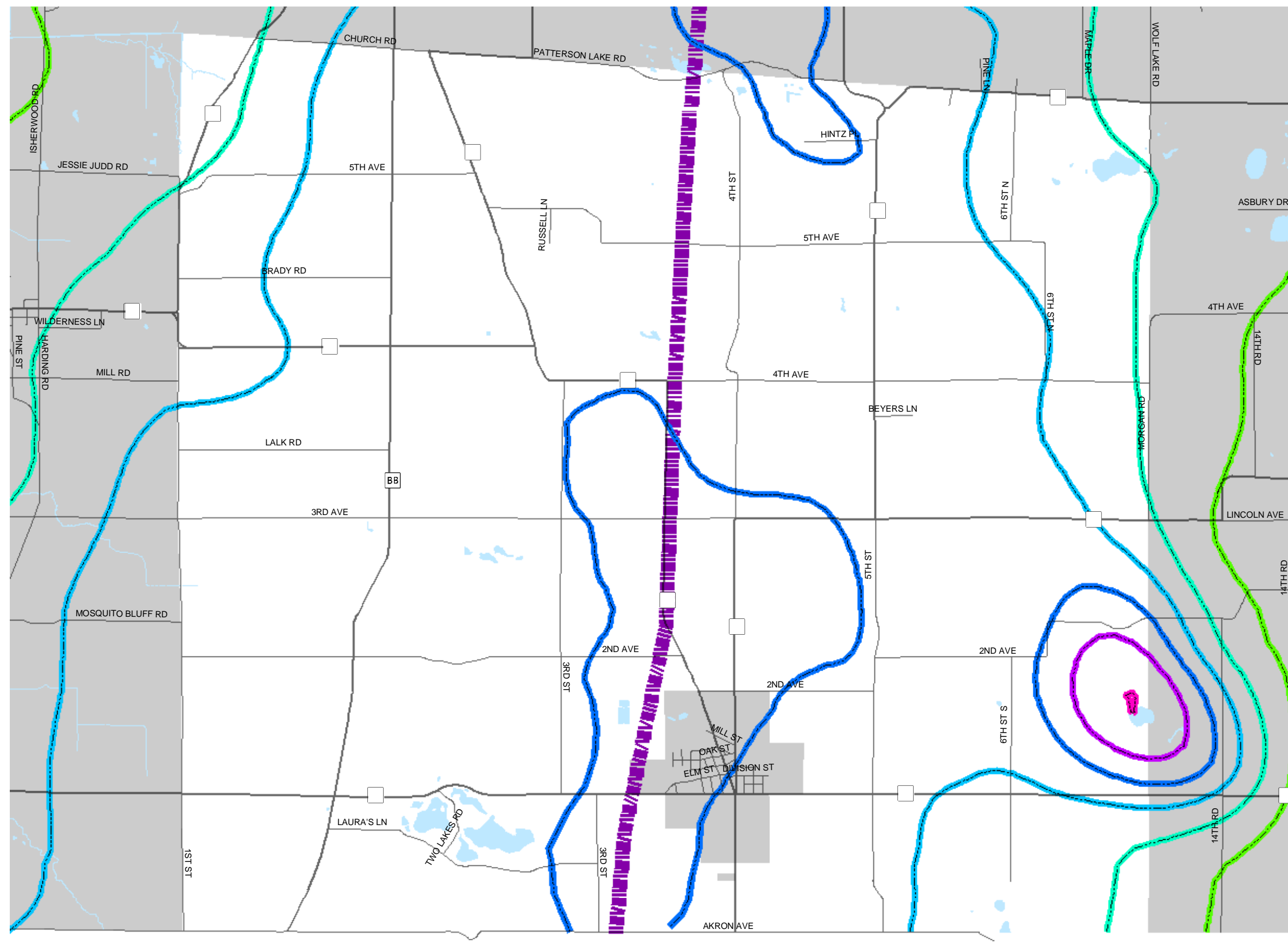

Groundwater Elevation (ft. above sea level)

- 1070
- 1080
- 1090
- 1100
- 1110
- 1120

▨▨▨▨▨ Groundwater Divide

Direction of travel

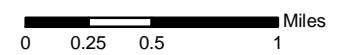

Source: Portage County Planning & Zoning (2004)

Map Produced: October 20, 2004

Town of Almond Comprehensive Plan

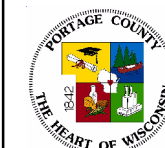

Portage County
Planning & Zoning
1462 Strongs Ave.
Stevens Point, WI 54481