

WINNEBAGO COMMUNITY

STRENGTHENING OUR COMMUNITY THROUGH INFORMATION AND EDUCATION

Third Quarter 2003
Volume 5, Issue 1

Inside This Issue

Comprehensive Planning
Update 2

What is Public
Participation 4

Local Government Training
Opportunities 4

Current Issue Facing Local
Governments & Training
Opportunities Registration
Forms 5

New Winnebago County
Stormwater and Erosion Control
Ordinance Aims to Protect
Winnebago Waters 6

Did you know? - Healthy
Waters-Healthy Communities
..... 8



Winnebago County
The Wave of the Future

Winnebago Community
produced by:
Catherine Neiswender
Community Development
Educator
UW-Extension,
Winnebago County
Linda Block, Secretary

WELCOME TO WINNEBAGO COUNTY

CATHERINE NEISWENDER

After a long hiatus, the Winnebago Community Newsletter is back! The focus of this newsletter is aimed at strengthening our community's ability to address local issues through education, information, and citizen participation. This newsletter will be published on a periodic basis, providing local officials, community



groups and interested citizens information regarding emerging issues and trends in the areas of community, natural resources and economic development.



WELCOME CATHERINE NEISWENDER

Greetings! I want to take this opportunity to introduce myself to you as the new UW-Extension Community Development Educator for Winnebago County.

I took over for Mike Koles on June 1 of this year after Mike moved on to the UWEX Community Development Educator position in Waupaca County in January. I have worked for UW-Extension for the past 5 years in a couple of different positions, including Fox-Wolf Basin Educator, where I was housed in the Winnebago County UWEX office, and most recently as Regional Water Quality Liaison in Madison. I am married and my husband, Eric, works as a counselor at Notre Dame Academy in Green Bay. We live in Appleton and enjoy being back in the Fox Valley area. My interests are diverse and include music, outdoor silent sports and, most recently, fixing up our 103-year old house.

The Community, Natural Resource and Economic Development Program is focused on building strong communities and enhancing local decision making through education and information. More information about my program can be found on the Winnebago County website at <http://www.uwex.edu/ces/cty/winnebago>.

I am very excited to be back in Winnebago County as I truly enjoy the people I work with and the diversity of strengths and interests in the county. I look forward to meeting and working with you and your community in the future.

Sincerely,

Catherine Neiswender
Community Development Educator
Winnebago County UW-Extension

COMPREHENSIVE PLANNING UPDATE

Edited by Jerry Bougie, County Planning Department

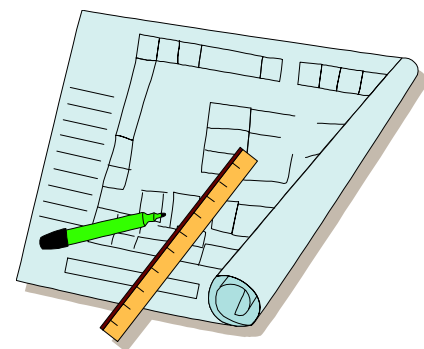

Much work has been done on the County Comprehensive Planning Process since the last newsletter. The consulting firm Planning and Design Institute (PDI) was hired to develop a Draft Comprehensive Plan in consultation with the Planning Advisory Group (PAG). Bert Stitt of Stitt Facilitations was hired to facilitate the process and concentrate on developing an understanding between the Towns and the County. The Planning Advisory Group, who oversees the process, consists of representatives from the municipalities across the county, the County Planning Department, and UW-Extension. Two Open Houses were held in November, 2002 and May, 2003 and a series of Focus Group discussions were held in January 2003 to gain input on concerns, feelings and ideas for the comprehensive plan.

There is now a County Plan website which contains meeting information, a copy of the Draft Plan, much of the background information that was developed during the Planning Process, and more. The website is: <http://www.uwex.edu/ces/cty/winnebago/wcplanning>.

Two Parts of the Draft Plan

The Draft Comprehensive Plan, as developed by the consulting firm Planning and Design Institute (PDI), is comprised of essentially two parts. The first part is the Future Land Use map of the County. This map is currently comprised of the adopted land use plan maps of all 22 municipalities in the County. These individual maps are 'stitched together', like a quilt, to provide an overall future land use picture of Winnebago County. This map is a generalization of land uses depicting broad categories of land use types such as Single-Family Residential, Industrial, Agriculture, etc. These broad categories are further defined by the individual local land use plans. This approach recognizes and allows for the variations in local conditions developed by local citizens and decision-makers.

Not all Towns have completed or updated their future land use map. In these cases, the Draft Comprehensive Plan outlines several potential policies for incorporating the local plan into the county plan. One approach is to stitch in the most recent land use map or zoning map. Another approach would be to use the Policy Framework Map (see next paragraph) in lieu of the Towns' land use or zoning map. These alternatives are still being discussed by the Planning Advisory Group. When Towns have an updated future land use map, the County will utilize this map as part of the stitched Future Land Use map.

The second part of the Draft Comprehensive Plan is a Proposed Policy Framework that will be used to evaluate future local land use plans and County Plan amendments. The Framework consists of a series of Districts and Corridors, each with its own definition and set of policies for housing, commercial uses, agriculture and natural resources, and utility and community services.

The Corridors are:

- Regional/community – primarily linear transportation routes throughout the county (Hwy 41, 110 and 45) and roads that connect communities (Hwy 26, 91, 44, 150 and 10).
- Environmental corridors – contiguous, generally linear areas that include major environmentally sensitive areas such as woodlands, wetlands and steep slopes.
- Railway Corridors
- Shoreland Corridors – developed and undeveloped land adjacent to lakes and rivers

The Districts include:

- Agriculture District – large contiguous areas of agriculture and undeveloped land
- Urbanizing District – areas adjacent to developed areas and transportation arterials that are likely to see their land use change in the next five to ten years
- Urban District – areas where land is fully developed, primarily the cities of Oshkosh, Neenah, Menasha and Appleton
- Village Center – urbanized areas separated from other urban areas, primarily City of Omro, Village of Winneconne, Waukau, Eureka, Clayton and Larsen.

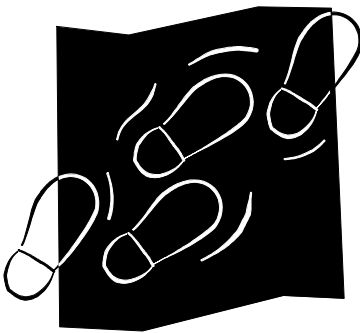

Next Steps – the Plan Review and Adoption Process

The Draft Plan is currently being reviewed by the Planning Advisory Group (PAG) and municipalities. Local governments have been asked to submit initial comments to the Planning Advisory Group by September 12 for consideration. This is an important step in the process as the Plan moves closer to adoption by the County Board. The following diagram outlines the next major steps in the review and adoption process of the Draft Plan.

How to Comment:
 The plan can be reviewed at the UW-Extension office at the Comprehensive Planning display booth. Comments can be sent to Jerry Bougie at (920) 236-4839 or jbougie@co.winnebago.wi.us.

Step 1 -- Draft Plan Development by consultant for PAG 	Step 2 -- PAG submits Draft Plan to County Planning and Zoning (P&Z) Committee	Step 3 -- Joint Public Hearing and Workshop with P&Z and PAG	Step 4 -- Presentation of full Plan to all governing bodies at a single meeting	Step 5 -- Local governments have 60 days to review and respond to P&Z with comments
---	--	--	---	---

We are here

Step 6 -- P&Z submits changes to the PAG.	Step 7 -- Draft Plan is sent back to local governments for a 45 day review. Local governments submit a Yes or No vote of support (not adoption)	Step 8 -- P&Z hold public hearing on the Comprehensive Plan	Step 9 -- P&Z forwards recommendation of approval to the County Board	Step 10 -- County Board action on the Comprehensive Plan
---	---	---	---	--

WHAT IS PUBLIC PARTICIPATION?

Public Participation throughout the Draft Comprehensive Plan Review and Adoption Process is critical to building an understanding of the contents of the Plan, how the Plan works and what the concerns of the local municipalities are. Public Participation, as defined by the International Association for Public Participation, is “any process that involves the public in problem-solving or decision-making and uses public input to make better decisions.” Public Participation is also required as part of the Comprehensive Planning Law (Smart Growth Law) as local governments develop their local comprehensive plans.

In general, at all stages of a planning process, local governments seek to accomplish specific purposes through citizen participation. For example, the local government may seek to inform citizens, identify their issues and community opportunities, learn what the citizens want, gather data, test ideas, review the plan and build support for the plan. Citizens participate to accomplish some of their own purposes such as learning and staying informed, providing information, dialoguing with officials and expressing preferences. Well planned citizen participation programs try to address the purposes of both the planners and the citizens. In this manner, the citizen participation plan operates parallel to, in support of, and in coordination with the overall planning strategy.

A subcommittee of the Planning Advisory Group developed detailed public participation

recommendations for the Plan Review and Adoption Process discussed in the previous article. A Public Participation Plan has been drafted and is currently being reviewed by the County Planning and Zoning Committee for adoption by the County board in September.

What is important to remember is that it is every citizen's right and responsibility to take the opportunity to participate in the comprehensive planning process. Regular and continuing involvement in government decision-making is the very basis for the idea of citizenship.

Citizen participation is likely to produce better decisions by utilizing the knowledge of the populace and by allocating part of the responsibility for formulating and implementing decisions to the citizens.

There are several ways to participate in the Plan Review and Adoption Process.

- Attend Planning meetings – a schedule is posted on the planning website
- Get on the mailing list - contact the UW-Extension office
- Talk with your local elected and appointed officials
- Sponsor a speaker at your social or civic club
- Submit written or email comments to the County Planning department

The County Plan website contains meeting information, a copy of the Draft Plan and more. The website is: <http://www.uwex.edu/ces/cty/winnebago/wcplanning>.



LOCAL GOVERNMENT TRAINING OPPORTUNITIES

The UW-Extension Local Government Center is once again offering its WisLine Teleconference Series on **Current Issues Affecting Local Government Officials**. Please refer to the following page for registration information. The Winnebago County UW-Extension building is a host site for these teleconferences. When registering, please note the location site #4083 refers to the J.P. Coughlin Center at 625 E. County Rd. Y, Oshkosh, Wisconsin.

The Local Government Center is also offering **Local Finance and Elections Workshops** (for Towns and Villages). Please refer to the following information for registration information.

**CURRENT ISSUES AFFECTING
LOCAL GOVERNMENT OFFICIALS
2003 - 2004**

WisLine Teleconference Series

Sponsored by: UW-Extension Local Government Center, League of Wisconsin Municipalities, Wisconsin Counties Association, and Wisconsin Towns Association

Location: 4083

Name _____

Address _____

City _____ **Zip** _____

Phone _____

E-Mail Address _____

Government Unit _____

Check session(s) you wish to attend

Date	*WisLine Session \$12	Materials Only \$12
Sept. 8, 2003 -- (1696-1) Developing the Annual Budget		
Oct. 14, 2003 -- (1696-2) Legal & Practical Considerations When Reducing the Govt Workforce		
Nov. 12, 2003 -- (1696-3) Health Insurance Benefits for Local Govt Employees		
Dec. 9, 2003 -- (1696-4) Alternative Financing Sources for Local Governments		
Feb. 10, 2004 -- (1696-5) The State Budget & Financial Condition		
Mar. 16, 2004 -- (1696-6) How to Run the Annual Town Meeting		
April 13, 2004 -- (1696-7) Regulations of Alcohol Beverage Licensing		
Total Amount		

*WisLine session includes materials

Mail form and fee to: WisLine Registrations
Dept. 111, Room 139
702 Langdon Street
Madison WI 53706-1487

Fax : 1-800-741-7416

Method of payment: VI _____ MC _____ AX _____
Credit card # _____
Cardholders name _____
Exp. date _____
Bill me _____ **Check enclosed** _____

[Make check payable to UW-Extension]

UW-Extension provides equal opportunities in employment and programming, including Title IX

**LOCAL FINANCE & ELECTIONS
WORKSHOPS
(For Towns and Villages)
2003 Fall Program**

Sponsored by: League of Wisconsin Municipalities, Wisconsin Towns Association, Wisconsin Department of Revenue, State Elections Board, and UW-Extension Local Government Center

REGISTRATION INFORMATION

Name _____

Govt Unit _____

New Official **Continuing Official**

Address _____

City _____ **Zip** _____

Phone () _____

I plan to attend the following workshop:

- _____ #1687 Fond du Lac, Sept. 9
- _____ #1688 Whitewater, Sept. 10
- _____ #1689 Mineral Point, Sept. 11
- _____ #1690 Eau Claire, Sept. 15
- _____ #1691 Cable, Sept. 16
- _____ #1692 Rhinelander, Sept. 17
- _____ #1693 Tomah, Sept. 23
- _____ #1694 Stevens Point, Sept. 24
- _____ #1695 Green Bay, Sept. 25

FEE: \$47 early registration and \$55 at door
Walk-ins accepted if space permits

Fee covers the cost of instruction, materials, snack & lunch. For materials only (\$20), call 608-262-9961. **Registrations and/or cancellations must be received 5 full business days prior to the workshop.** The five-day notice is required for a refund when canceling registration.

Space is limited. Early registration is suggested.

Telephone (information only): 608-262-9961
Telephone (registration only): 608-262-2451
Fax: 1-800-741-7416

Mail form and fee to: Pyle Center
Registrations/Financial Workshops
702 Langdon St., Dept. 104
Madison WI 53706-1487

Method of payment: VI _____ MC _____ AX _____
Credit card # _____
Cardholders name _____
Exp. date _____
Bill me _____ **Check enclosed** _____

[Make check payable to UW-Extension]

NOTE: Please call the extension office for a complete brochure if you need further information.

NEW WINNEBAGO COUNTY STORMWATER AND EROSION CONTROL ORDINANCE AIMS TO PROTECT WINNEBAGO WATERS

On September 1, 2003, the new county Stormwater and Erosion Control ordinance will be implemented. The new ordinance is the culmination over a year's worth of work by the Stormwater Technical Advisory Committee (STAC) to work to address stormwater concerns in the county.

What does this mean? In the long run, it means that a concerted effort to reduce the amount of stormwater and soil running off construction sites will contribute toward the protection and improvement of the surface water in Winnebago County. In the short term, it means that towns, communities, contractors, utility workers and home builders will have a new set of regulations to comply with when they are working on a new construction project. This ordinance also helps the county move toward compliance with new state (NR 216 and NR 151) and federal regulations (EPA Phase II regulations) aimed at stormwater management.

“Stormwater Impacts”

Stormwater is a natural occurrence in our landscape, but as we experienced earlier in July, too much stormwater can cause flooding problems on roads and in basements. Ever increasing amounts of impervious surface, that is, driveways, roads and parking lots, causes water to run off rather than to soak in. Prior to development, the land was much more capable of absorbing rain. Stormwater runoff can also degrade streambanks by causing erosion and can carry a variety of pollutants, such as sediment, chemicals, motor oil, bacteria and other urban pollutants directly into lakes, rivers and wetlands.

So what's wrong with soil? Soil, or sediment, is a natural element in our rivers and lakes, but in excess it can cause problems. Excess sediments can impair fish and wildlife habitat and destroy spawning areas for bass, walleye, and other fish. Murky water also hinders the penetration of sunlight needed for growing aquatic plants and impedes navigation. Essentially, excess sediments disrupt a natural balance in the water. Excess sediments also typically carry with them pollutants such as nutrients (fertilizers) and chemicals from lawn or agriculture lands which can further impair water quality and habitat.

Who is affected by the new ordinance? The ordinance applies in all unincorporated areas of Winnebago County. The ordinance applies to land-disturbing activities, new land development and all land redevelopment in the unincorporated areas of the county conducted by landowners, general contractors, engineering firms or corporations. This includes utility companies, towns, sanitary districts, “earth-working” companies and builders. Towns and building inspectors should understand the new ordinance as they are often the first in line to answer questions and handle development requests in their town.

Currently the Towns of Algoma and Menasha will administer this ordinance in their jurisdiction, and other towns may administer it in the future. The County Planning and Zoning Department will be working with the Land and Water Conservation Department and R.A. Smith & Associates, Inc. to administer the ordinance in the remaining unincorporated areas.

What is required? There are three types of permits for stormwater and/or erosion control depending on the situation. These include:

1. **Erosion Control permits** for land disturbance of 4,000 square feet or more. This includes excavation and filling of 400 cubic yards or more, all public or private roads or driveways longer than 125 feet, new one and two family residences, and any new agriculture, commercial or industrial buildings or additions disturbing more than 4,000 square feet. These permits must be accompanied by an erosion control plan.
2. **General annual permit** for road ditch maintenance by towns and utility work. All permits must be accompanied by an erosion control plan.
3. A **Stormwater Management Permit** is required for all land development and redevelopment activities including commercial, industrial, multi-family developments and platted sub-divisions. These permits must be accompanied by a stormwater management plan, a maintenance agreement and a non-refundable permit fee. There will also be a pre design meeting fee and additional escrow fees or financial assurances may be required by the developer or property owner to cover expenses of review and inspection of the plan and project.

Permit fees will not piggy back, so if your project requires an erosion control permit and a stormwater management permit, only one fee will be assessed. Details of the permit requirements and fees can be found in the ordinance.

What are neighboring municipalities doing? Winnebago County has been recognized as a regional leader in stormwater management much like the City of Neenah and Towns of Clayton and Vinland have been recognized as local models of success in collaborating across government lines to manage watershed level issues. Outagamie County is in the midst of developing a process that mimics the Winnebago County process. Fond du Lac County has used our draft ordinances as models to develop their draft ordinances. Throughout the ordinance development process, other counties and several consulting firms have requested copies of the draft ordinances for their review as well.

The City of Oshkosh recently adopted a stormwater utility, and plans to use the Winnebago County ordinance as a model when they update the existing city stormwater ordinance. Consistency between the city and county ordinances should make the permitting process easier for developers as requirements would be similar. Consistent regulation and enforcement throughout the county will also benefit the water resource.

Where can I find more information? A copy of the ordinance can be obtained from the County Planning and Zoning Department for the cost of \$1.10. Contact Rick Hoeft at 236-4844 or rhoeft@co.winnebago.wi.us. You may also download a copy on the web at: <http://wclwcd.org/PDF%20Files/Stormwater%20Ord%20ver.pdf>.

Previous issues of the Winnebago Community newsletter discuss the background and development of the Winnebago County Stormwater Ordinance. These can be found on the website, or you can obtain hard copies of these newsletters from the UW-Extension Office. Relevant Issues:
June 2002, Volumes 2, 3 and 4



Winnebago County UW-Extension
625 E. County Rd. Y
Oshkosh, WI 54901-8131
Phone: 920-232-1972
Fax: 920-424-1277
Email: catherine.neiswender@ces.uwex.edu

Non-Profit
U.S. Postage
PAID
Permit No. 527
Oshkosh WI
54901

We're on the Web!

<http://www.uwex.edu/ces/cty/winnebago>

University of Wisconsin, United States Department of Agriculture and Wisconsin Counties Cooperating An EEO/Affirmative Action Employer. University of Wisconsin-Extension provides equal opportunities in employment and programming, including Title IX and ADA requirements.

DID YOU KNOW?

Healthy waters-Healthy communities

According to a Wisconsin Department of Tourism study, travelers in Winnebago County brought in \$222 million in 2002 - a 101% increase over the past decade. The natural environment and water and trail-based recreational opportunities provided by Lake Winnebago and its connecting lakes, rivers and wetlands are a significant draw for tourists and visitors who spend their money in Winnebago County. Businesses that cater to tourism such as resorts, motels, campgrounds, and retail stores, complement the water and trail-based recreational opportunities in the county. Protection of the county's natural resources, including efforts to improve stormwater management and erosion control, is a critical strategy for ensuring a viable recreation and tourism base that contributes to the local economy.